

Kanlux

SURFACE-MOUNTED FITTING
Kanlux BLURRO



Kanlux

Kanlux BLURRO
New form
of ceiling-mounted
fitting with **spot**
functionality

Light fitting
dedicated
for ceiling
mounting.

Kanlux

Kanlux BLURRO
Light fitting with
one or two lighting
points



32950



BLURRO **GU10** CO-B



32952



BLURRO **2XGU10** CO-B

Kanlux

Kanlux BLURRO
Light fitting with
one or two lighting
points.



32951



BLURRO **GU10** CO-W



32953



BLURRO **2XGU10** CO-W

The advertisement features a close-up of a black, cylindrical spotlight fixture with a textured, sandblasted finish. The fixture is positioned on the left side, with its lens and internal LED components visible. The background is a light gray, textured surface. A large, dark blue, textured triangular shape is overlaid on the right side of the image, containing white text. The Kanlux logo is in the top left corner.

Kanlux

Kanlux BLURRO
The highest
quality of
workmanship.

Minimalist
design.

Sandblasted
aluminum
housing

Kanlux

Kanlux BLURRO

It consists of 2 parts **the base**
mounted like a classic surface-mounted fitting
and the tube for a light source
which can be used, like in a spot light,
to adjust the angle of light.

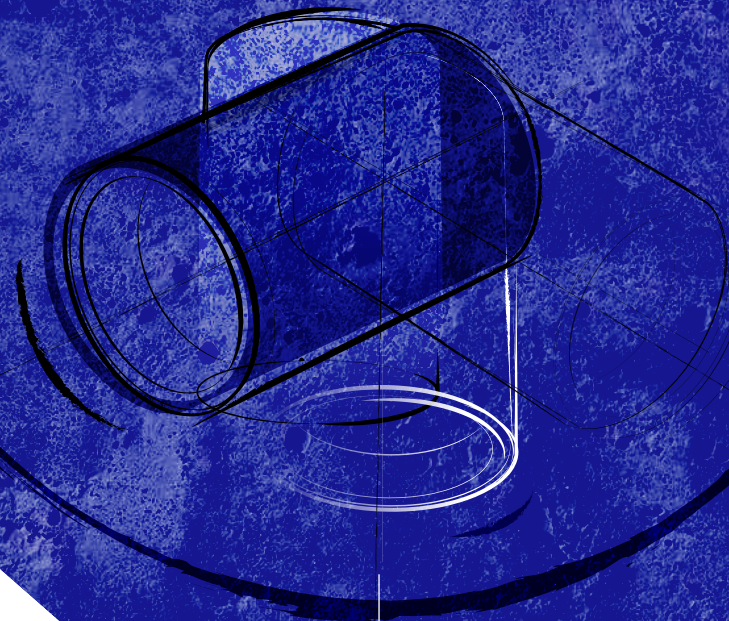

60°

Kanlux

Kanlux BLURRO GU10

●	BLURRO GU10 CO-B	32950
○	BLURRO GU10 CO-W	32951

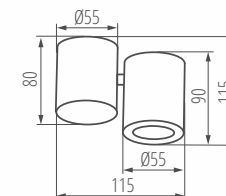

power supply: **220-240 V**
power: **max. 10W**
cap: **GU10**
angle adjustment: **60°**
material: **painted aluminum**
protection class: **I**
tightness: **IP 20**

Kanlux BLURRO 2XGU10

●	BLURRO 2XGU10 CO-B	32952
○	BLURRO 2XGU10 CO-W	32953

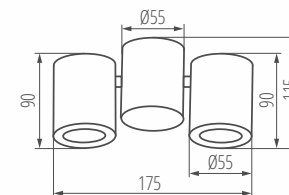

power supply: **220-240 V**
power: **2 x max. 10W**
cap: **GU10**
angle adjustment: **60°**
material: **painted aluminum**
protection class: **I**
tightness: **IP 20**



Kanlux

**Kanlux
BLURRO GU10 and BLURRO 2xGU10**



well packed

kanlux.com

